



HO Scale Structure Kit

PERFECT PERK CAFE

933-3468

Thanks for purchasing this Cornerstone Series® kit. Please read all instructions and study the drawings before starting — directions for the interior graphics are printed directly on that sheet. All parts are styrene plastic, so use compatible glue. If you wish to decorate your model, use paints for plastic models. With appropriate details and signs, your finished model fits almost any era.

Nothing beats a good cup of coffee and it's been one of our favorite beverages for thousands of years. But don't confuse coffeehouses with the more recent "coffee shop," which is basically a short order diner, for the true coffeehouse serves only coffee and snacks. Legend has it that the first, the "Kiva Han" opened in Istanbul, Turkey in 1475. Over the next two centuries, coffee and coffeehouses spread gradually across Europe, becoming important places for men to conduct business, and meet and socialize with clients and friends. America's first coffee house opened in 1792, serving the same functions as those in Europe. Although easy to make and affordable enough to prepare at home, the social aspects of coffee houses kept them going for generations to come, especially among younger patrons who were not welcome at pubs and bars, and adults who preferred to socialize without alcohol. This was especially true in the 1950s and 60s, when adults came to view them as a hangout for beatniks and teenagers. Over the next decades, the coffee house would gradually reinvent itself and modernize its image, still offering its basic menu of coffees and light snacks, while serving as a favorite meeting place. While national chains have become common, many local operations have returned to revitalized downtowns and commercial areas, occupying all kinds of historic buildings.

For more Cornerstone Series® kits as well as additional details to complete your scene, see your hobby shop, check out the latest Walther's HO Model Railroad Reference Book and our Website at walthers.com.

1. Glue Window and Door Frames to each Wall as shown. Glue Window Glass in place as shown. Interior windows can be added at this time (refer to printed interior sheet)

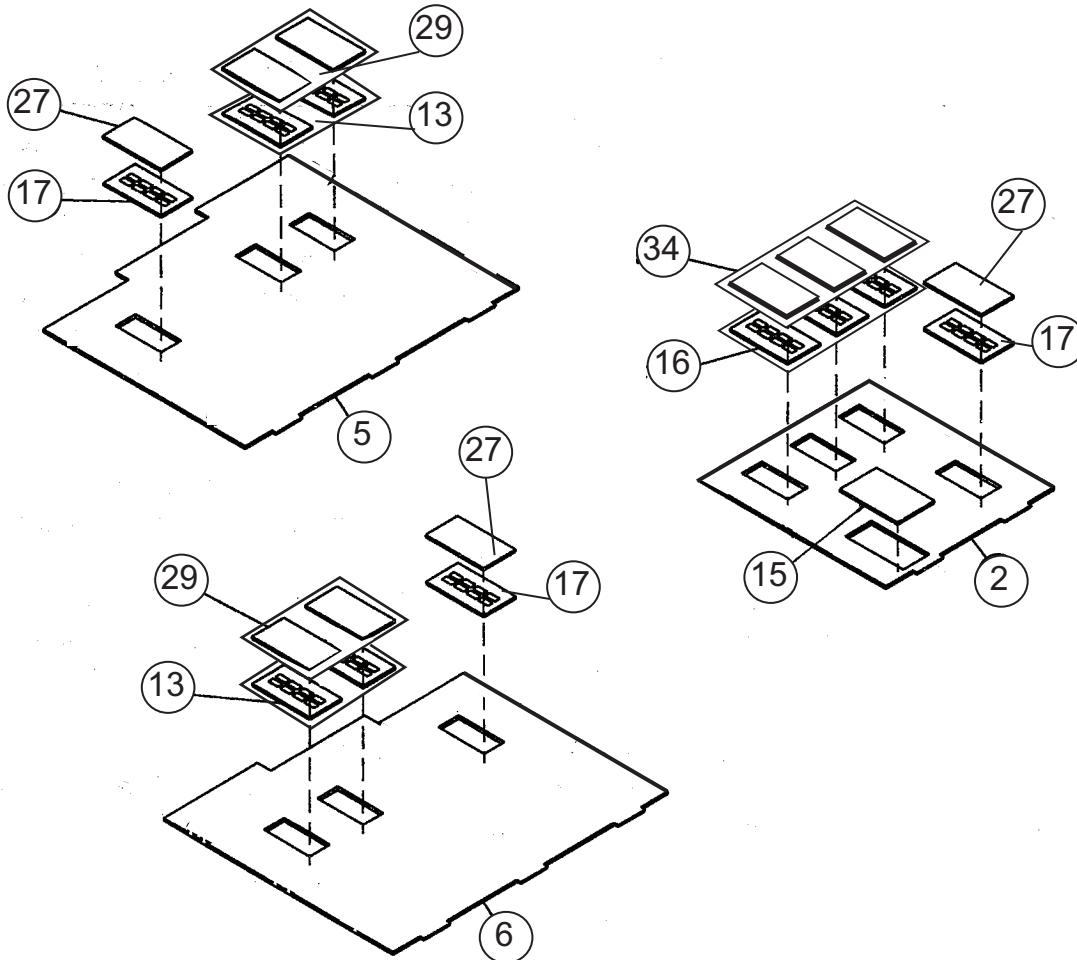

2. Glue the cornice (20) into the top of the front wall (3).
3. Glue the Glass (30) into the Bay Window (19), then glue the Bay Window into Wall 3.
4. Glue the Small Upper Window (18) into Wall 3 and add the Glass (28).
5. Glue the Storefront (12) onto the back of Wall (3). Then glue the Storefront Glass (32) onto the back of Storefront (12).
6. Glue the 4 walls together, then glue the Roof (9) to the walls.
7. Glue the 2 Chimney Halves (8) together and then glue on the cap (10). Glue the assembled chimney into the Roof (9).
8. The finished structure can be set on the Base (1) if you wish to add interiors details at a later time, or glued in place to complete construction.

NOTE: If you plan to use your model with Walthers Street System, trim the front sidewalk from the Base (1).

NOTE: Perfect Perk Cafe uses Sign #24.

